

## Specifications

The contractors are responsible for the construction of the new Saleyard Facility at Maxwellton. Specifications for this project are as follows;

1. Yards are compiled of the following sized holding pens;
  - 1.1. Six (6) 12m x 21m holding yards including a gate for access
  - 1.2. One (1) 15m x 21m holding yard including a gate for access
  - 1.3. One (1) 9m x 36m laneway for access to yards
  - 1.4. Erection of prefabricated Double Deck Cattle Loading Ramp & Catwalk
  - 1.5. Construction of loading ramp and platform for train
2. Holding Yard Specifications
  - 2.1. All running posts to be 3m apart
  - 2.2. All posts to be concreted at a depth of 1m
  - 2.3. Top of the concrete footing to be 75mm above the ground and sloped away from the post
  - 2.4. Running posts to be connected by 5 running Rails 3m in length.
3. Cattle Crush
  - 3.1. Cattle crush to be installed where specified in provided plans
4. Gate Specifications
  - 4.1. All gates are to be three (3) meters in length
  - 4.2. All gates are to have 5 running rails at the same distance as the fence.
5. Water troughs are to be installed in specified positions as per design.
  - 5.1. Water troughs are to be sat on a concrete pad
  - 5.2. Concrete to be supplied and installed by the contractor
  - 5.3. Plumbing for water to be completed by Richmond Shire Council
6. 600m laneway to be installed connecting cattle to old yard facility
7. Richmond Shire Council to Provide troughs and plumbing for troughs. It is the responsibility of the contractor to install. The size of the pad is to be discussed when the tender is awarded.

## Materials Purchased

### \*\* CATTLE YARDS \*\*

75 X 75 X 4.0 X 12000 MM ALLGAL  
75 X 75 X 4.0 X 6000 MM ALLGAL  
75 X 75 X 4.0 X 12000 MM ALLGAL  
WOP 27A MM HINGE SET  
SLAM CATCH 25 MM AND STRIKER  
50 X 50 X 4MM X 8000 MM ALLGAL  
8MM GAL REGULAR CHAIN X 1000

### \*\* CATTLE FEEDERS CONSTRUCTION \*\*

75 X 75 X 4.0 X 12000 MM ALLGAL  
75 X 75 X 4.0 X 6000 MM ALLGAL  
50 X 50 X 4MM X 8000 MM ALLGAL  
SHEET 1200 X 2400 X 1.5 GAL

### \*\* LANEWAY \*\*

50 X 50 X 4MM X 8000 MM ALLGAL  
75 X 75 X 4.0 X 12000 MM ALLGAL  
WIRE ROPE GUIDES  
8 MM CATTLE CABLE X 400 MTRS  
CAP 75 SQ GAL  
115 X 42 X 2.5 OVAL RAIL

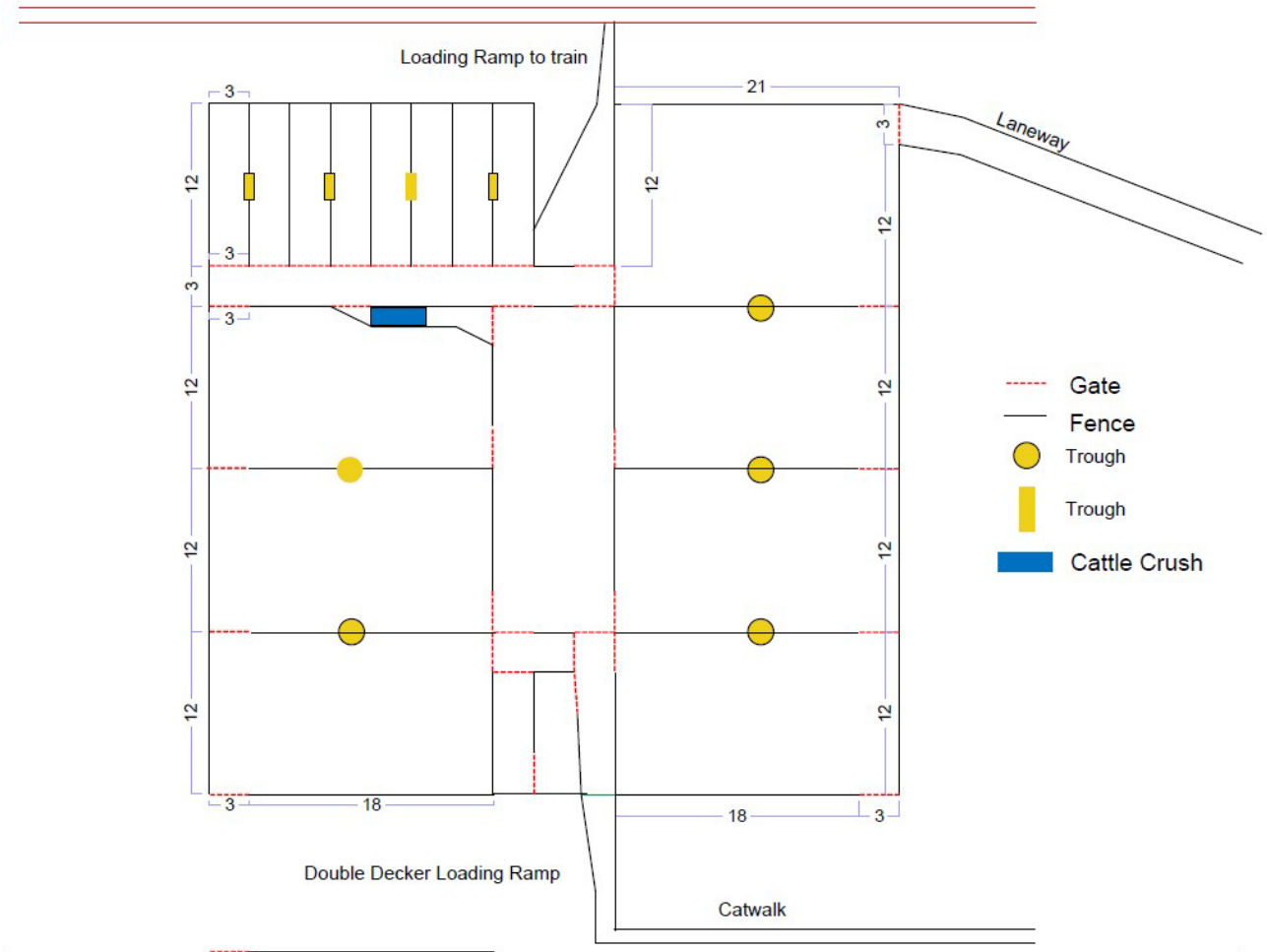

Road to Maxwellton

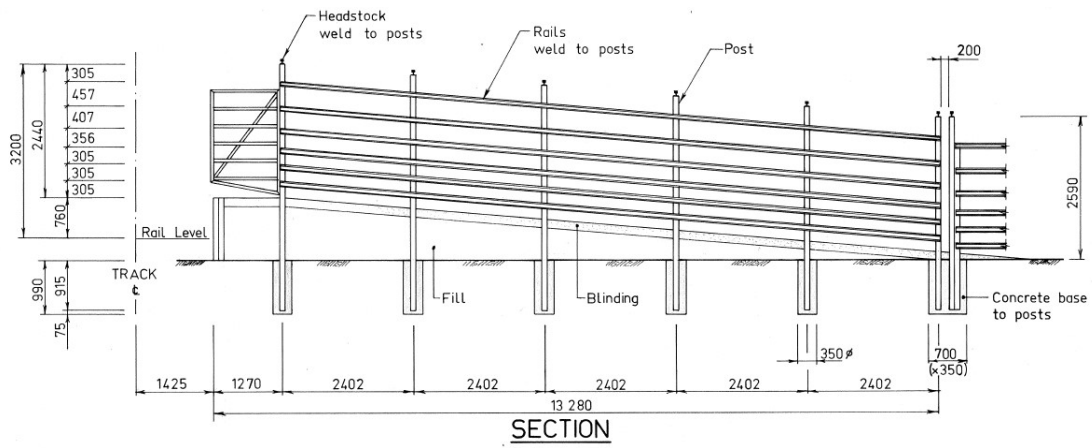

Cattle ramp to train.

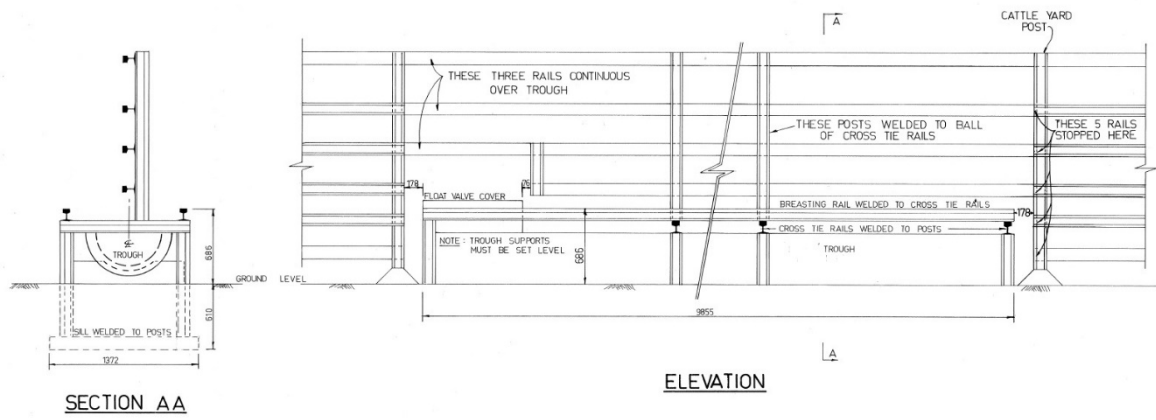

Trough Installation

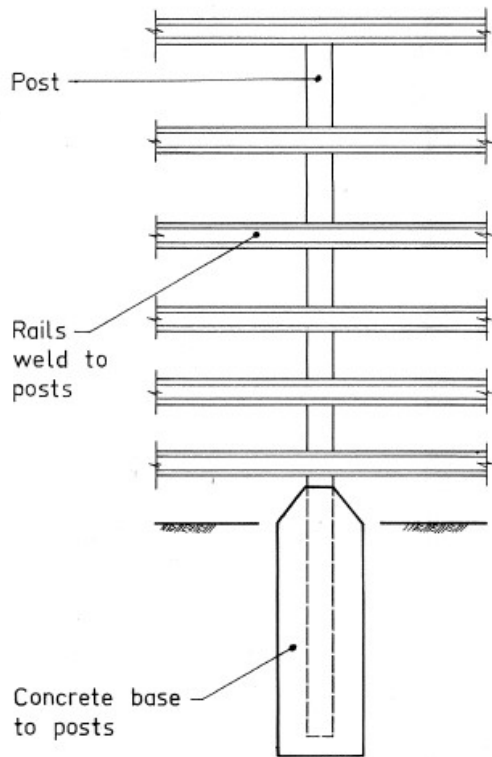

Post and Rail

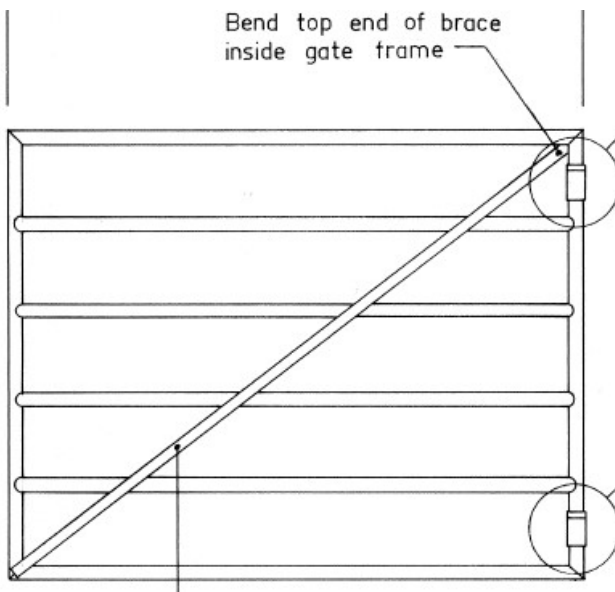

Yard Gate